

FirmamaticTM

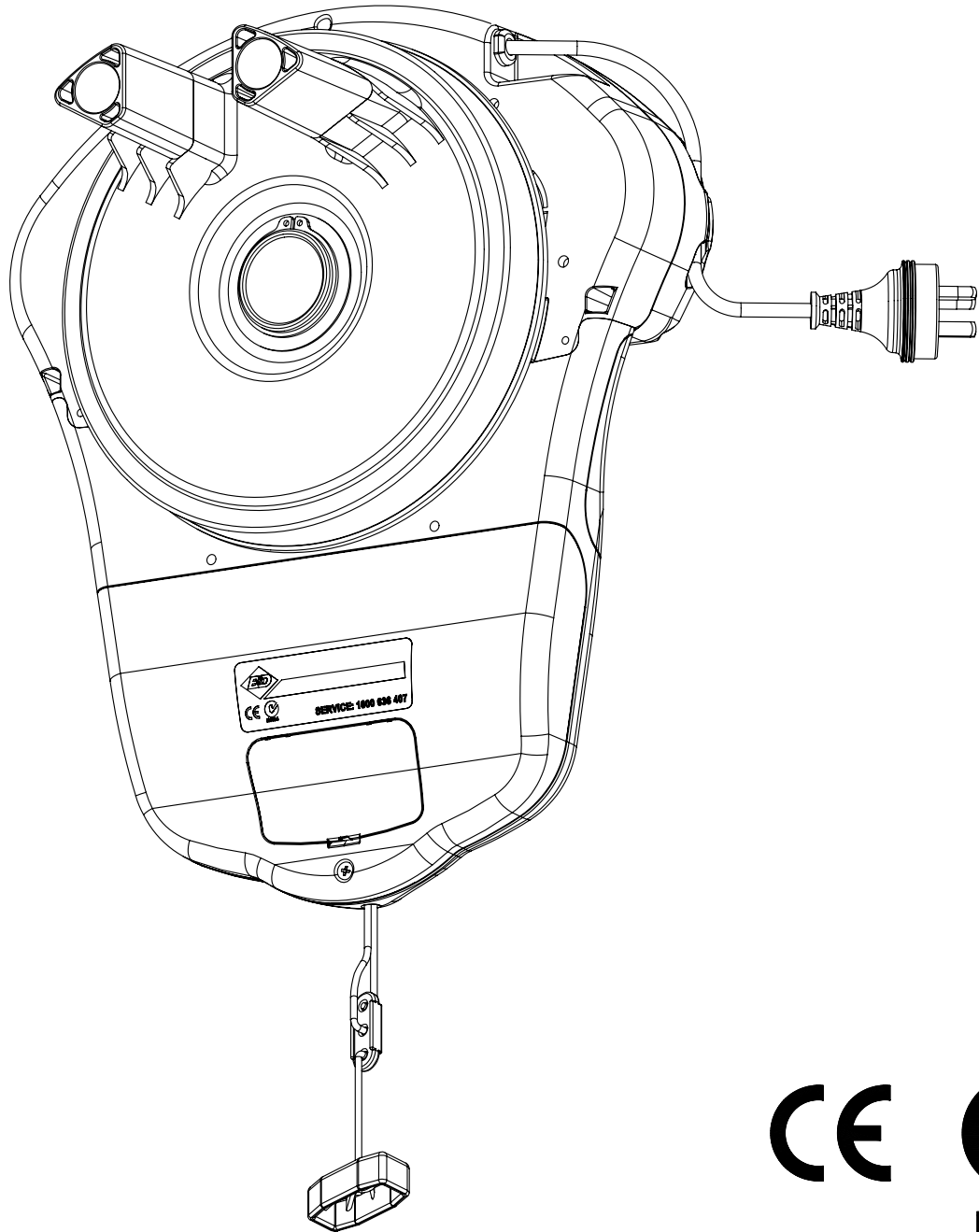

CE 
N1854

Instruction Manual



B&D Doors is a Division of B&D Australia Pty Ltd ABN 25 010 473 971
www.bnd.com.au

PLEASE READ THESE IMPORTANT SAFETY RULES



These safety alert symbols mean **Caution** – a personal safety or property damage instruction. Read these instructions carefully.



This Automatic Garage Door Opener is designed and tested to offer safe service provided it is installed and operated in strict accordance with the following safety rules. Failure to comply with the following instructions may result in serious personal injury or property damage.

Caution: If your garage has no pedestrian entrance door, an emergency access device should be installed. This accessory allows manual operation of the garage door from outside in case of power failure.



Position the Garage Door Opener so that the power plug is accessible when inserted into the power outlet (EN 60335-1)



This opener should be installed in accordance with relevant Australian Standards



Do not allow children to play with door controls (AS3350).



Keep remote controls away from children (AS3350).



Watch the moving door and keep people away until the door is completely opened or closed (AS3350)



Activate the opener only when the garage door is in full view, free of obstructions and with the opener properly adjusted.



Keep garage door balanced. Sticking or binding doors must be repaired. Garage doors, door springs, brackets and their hardware are under extreme tension and can cause serious personal injury. Do not attempt any garage door adjustment. Do not use if repair or adjustment is needed. Call for professional garage door service.



Install optional door control button in a location where the garage door is visible, but out of the reach of children at a height of at least 1.5m (AS3350).



Disconnect electric power to the garage door opener before removing covers.



Do not wear rings, watches or loose clothing while installing or servicing a garage door opener.



This opener is not suitable for commercial, industrial or common entry applications



To avoid serious personal injury from entanglement, remove all unnecessary ropes or chains and disable any equipment such as locks which are not needed for powered operation (AS3350).



Installation and wiring must be in compliance with your local building and electrical codes. Connect the power cord only to properly earthed mains. If an extension lead is used, make sure it is a 3 core lead and approved to 7 amp capacity.



If the supply cord is damaged, it must be replaced by the manufacturer or its service agent or a similarly qualified person in order to avoid a hazard.



When using optional auto close mode, a safety infrared beam (Part No 62153) must be fitted correctly and tested for operation at regular intervals. Extreme caution is recommended when using auto close mode. All safety rules must be followed



This opener is a plug in domestic appliance and is designed for indoor use only. It must be installed in a dry position that is protected from the weather.



The opener is not intended for use by young children or infirm persons without supervision

B&D Doors to the extent that such may be lawfully excluded hereby expressly disclaims all conditions or warranties, statutory or otherwise which may be implied by laws as conditions or warranties of purchase of a B&D Doors Garage Door Opener. B&D Doors hereby further expressly excludes all or any liability for any injury, damage, cost, expense or claim whatsoever suffered by any person as a result whether directly or indirectly from failure to install the B&D Doors Garage Door Opener in accordance with these installation instructions.

IMPORTANT SAFETY INSTRUCTIONS

WARNING – It is vital for the safety of persons to follow all instructions.

SAVE THESE INSTRUCTIONS

AS3350

SYSTEM SPECIFICATIONS

Maximum Door Size	3000mm high 5500mm wide (16.5m ²) Residential Rolling Garage Door or 2400mm high Wind Lock Residential Rolling Garage
Maximum Door Load	Door that does not exceed 200N (20kgs) bottom rail load. Recommended load 70N (7kgs)
Supply Voltage	220 - 240 V AC 50/60Hz
Current	Max. 1A
Lamp	LED (Light Emitting Diode) lighting; 2 X LED modules. Light comes on when door starts, off approx. 4 ½ minutes later, or can be programmed to operate from a remote control transmitter
Limit Adjustment	Electronic
Force Control	Electronic - fully automatic. Can be adjusted for environmental reasons
Transmitter Frequency	433.92MHz
Powerhead Weight	7.6kg
Auxiliary Power Supply	24-35VDC at 100mA
Rated Load	550N
Door Closed Status Output	Opto-isolated transistor output 35V 100mA. Connected to GND when door closed Note: Output will not be activated after power failure until a closed drive cycle has been completed - even if the door is closed
Auxiliary Output Supply	Opto-isolated transistor output 35V 100mA. Connected to GND when activated
External Aerial Connection	2-Pin Screw Connector AS3350

ABOUT YOUR FIRMAMATIC OPENER

Thank you for choosing a Firmamatic automatic garage door opener. This automatic garage door opener has been designed and developed in Australia by B&D Doors.

The technically advanced construction of this B&D opener ensures you enjoy the following benefits:

Warranty

Two (2) years full parts and labour warranty on motor electronics and mechanical components of the opener when installed by an approved B&D Dealer (conditions such as having the garage door serviced annually also apply).

Security Code

Your own private security code with over 3 billion available codes, meaning only you can open your garage door. Allows you to electronically program your security code at the touch of a button.

Multi-Channel Transmitter

Standard multi channel remote control transmitter allows you to operate other devices such as an adjoining garage door or automated gate.

Soft Start/Soft Stop

The opener eases into and out of an operating cycle. This makes operation smoother and quieter and most importantly reduces wear and tear on the door and opener.

Warranty Expired Indicator

When the opener reaches the number of cycles covered by warranty, the courtesy light will flash 10 times after each operation to indicate that warranty has expired. The flashing will continue for twenty cycles unless the opener is reset by pressing the LIMIT SET button while the courtesy light is flashing.

Safety Reversing System

Automatic safety reverse ensures personal protection from death or serious injury if trapped under a door while closing. Safety reverse force can be adjusted for environmental conditions, for example windy areas, etc.

LED Courtesy Light

Taking advantage of the latest advances in Light Emitting Diode (LED) technology your opener will never need to have the light globes replaced.

The LED courtesy light automatically switches on for approximately 4 ½ minutes (time programmable) when operating the door. Can be programmed to turn on and off from a remote control transmitter.

Manual Release

Emergency manual release handle (red knob) for manual operation of the door in the event of a power failure.

Disengagement handle doubles as a wireless transmitter, when pressed will operate door.

Memory Retention

Automatic memory of all remote control transmitter codes and door travel limits after a power failure.

Self Locking

No need to manually lock your garage door, as the opener 'positively' locks the door when closed.

Periodic Maintenance Indicator

The service LED will illuminate to indicate that periodic maintenance is required. Contact your dealer/installer for service.

Service Fault Indicator

Flashing LED's to easily identify operational problems or service requirements.

Dynamic Door Profiling

Automatically compensates for changes in door operating characteristics.

Auto-Close

Auto closing option can be programmed to close the door approximately 30 seconds after the door has opened. N.B. Safety Infra Red Beams must be installed for this option to function.

External Antenna

An external antenna can be connected - for sites where radio range can be a problem.

Vacation Mode

A transmitter can be programmed to disable the garage door opener radio receiver. This is ideal if the door is to be left idle for prolonged periods.

Pet Mode

A transmitter can be programmed to open the door partially to allow pets access to the garage. The door opening height is adjustable via a handheld programmer.

Door Status

Door Closed Output – for those situations when you need to know when the door is open.

Auxiliary Output

You can program a spare button of your remote control transmitter to operate this output to control items that can be switched using a momentary close.

Battery Back Up

Optional battery back up or solar power is available.

OPENER FEATURES

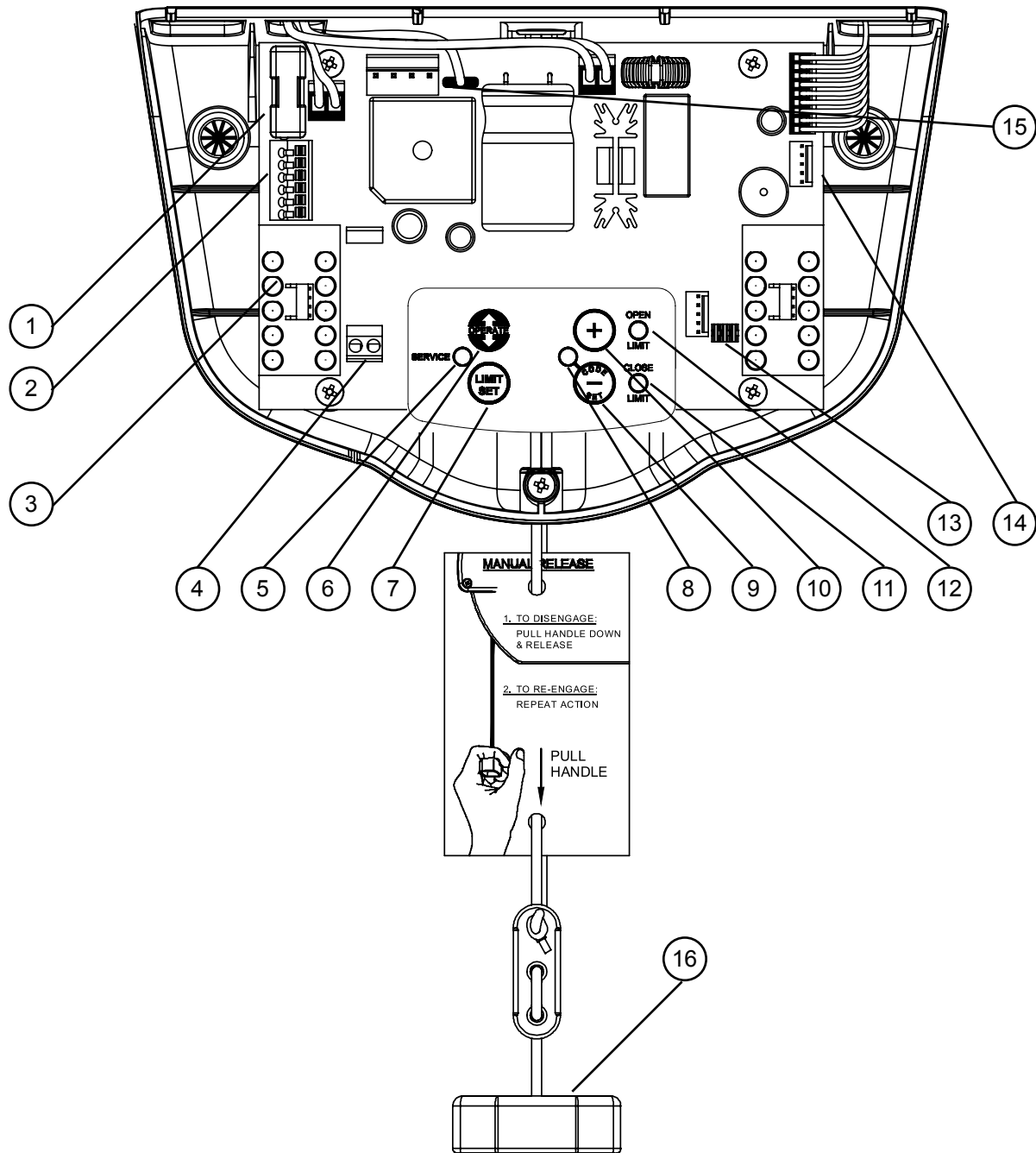

- | | |
|-----------------------------------|--|
| 1. FUSE | 8. CODE SET LED INDICATOR (RED) |
| 2. TERMINAL BLOCK - GND | 9. MINUS (-) AND CODE SET BUTTON (RED) |
| IR BEAM | 10. PLUS (+) BUTTON (GREEN) |
| 30V PWR | 11. CLOSE LIMIT LED INDICATOR (RED) |
| OPERATE | 12. OPEN LIMIT LED INDICATOR (GREEN) |
| CLS OUT | 13. JUMPERS - OPT 1 |
| AUX OUT | OPT 2 |
| 3. LED LIGHT ARRAY | AUTO-CLS |
| 4. ANTENNA TERMINAL | 14. UNIVERSAL PROGRAMMER CONNECTOR |
| 5. SERVICE LED INDICATOR (YELLOW) | 15. BATTERY BACK UP CONNECTOR |
| 6. OPERATE BUTTON (BLUE) | 16. MANUAL RELEASE HANDLE |
| 7. LIMIT SET BUTTON (BLACK) | |

TOOLS YOU MAY NEED FOR INSTALLATION

- ☐ Suitable door support
- ☐ Ladder
- ☐ Phillips screwdriver
- ☐ Suitable sockets and handle with a 150mm extension
- ☐ 450mm pipe wrench (Stillson) or similar
- ☐ Adjustable wrench or spanner set
- ☐ Marking pencil
- ☐ Tape measure
- ☐ Drill
- ☐ Drill bit 4.5mm for mounting weight bar
- ☐ Drill bit 3.2mm for pinning door curtain
- ☐ Length of rope

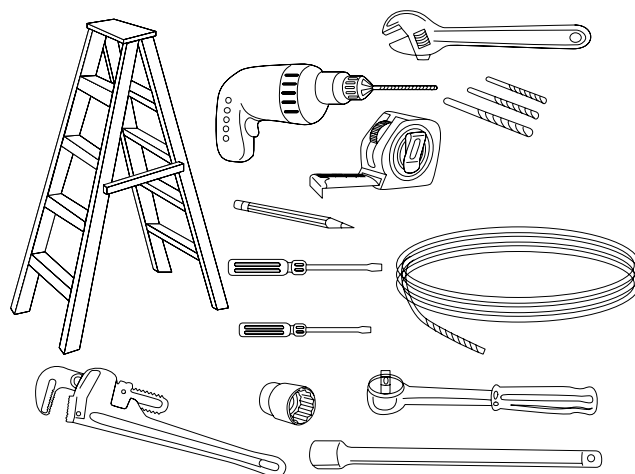

KIT CONTENTS

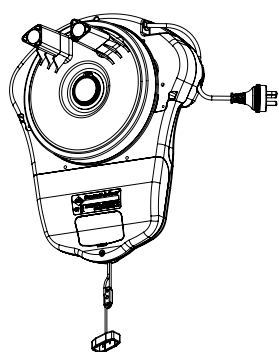

1. Powerhead

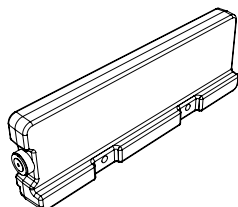

2. Weight Bar

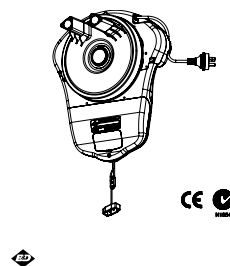

3. Instruction Manual

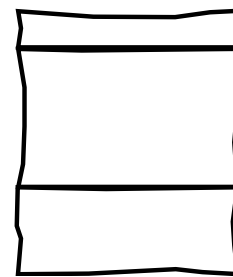

4. Installation Bag

1. Powerhead
2. Weightbar
3. Instruction manual and warning labels,
4. Installation bag containing:
 - a. Qty 2 Hand held remote control transmitter
 - b. Qty 2 Screw M4 x 50
 - c. Qty 2 3/16x1/2 flat washers
 - d. Qty 2 Nilock Nut M4
 - e. Qty 2 Hex head screw M6x45
 - f. Qty 2 Flat washer 107D 6.4x20.5x1.6
 - g. Qty 2 Ring gear extension fork
 - h. Qty 2 Screw 10x32 self tapping
 - i. Qty 2 Washer 6.4x20.6x1.2 to pin the door curtain
 - j. Qty 2 Locking bar covers
 - k. Qty 1 Coning collar kit
 - l. Qty 1 Transmitter wall bracket
 - m. Qty 2 Wall bracket screw
 - n. Qty 2 Wall plug

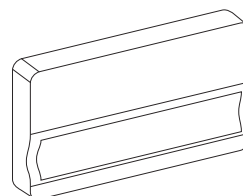

a. Qty 2



b. Qty 2



c. Qty 2



d. Qty 2



e. Qty 2



f. Qty 2

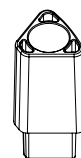

g. Qty 2



h. Qty 2



i. Qty 2

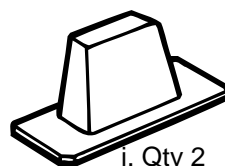

j. Qty 2

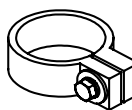

k. Qty 1

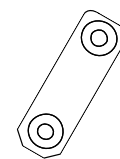

l. Qty 1



m. Qty 2



n. Qty 2

SECTION 1 - REQUIREMENTS

IMPORTANT SAFETY INSTRUCTIONS FOR INSTALLATION

WARNING – INCORRECT INSTALLATION CAN LEAD TO SEVERE INJURY

FOLLOW ALL INSTALLATION INSTRUCTIONS

AS3350

1.1 - DOOR OPERATION

The door must be in good operating condition and the maximum effort to move the door up or down, from stationary, should not exceed 200 Newtons (20kg force) at the bottom rail. The recommended force should be 70N (7kg) for manual operation.

Lift the door to about halfway, when you release the door it should stay in place supported entirely by its springs. Raise and lower the door to see if there is any binding or sticking.

The door may need to be serviced to meet these requirements – refer to the door manufacturer's servicing instructions or contact an authorised dealer.



Before installing the opener, check that the door is in good mechanical condition and correctly balanced and that it opens and closes properly

Note: The fitting of an opener to doors with removable mullions is not recommended.

1.2 - POSITION

The opener can be installed on either the right hand or left hand side of the door (when viewed from inside the garage).

This opener is not designed for external use. It must be mounted in a dry position that is protected from the weather.

Moisture or corrosion may damage the opener and this is not covered by the Warranty.

Do not allow water, or other liquids, to enter the opener or remote control transmitter.

1.3 - POWER SUPPLY



A properly earthed, 3 pin, single-phase power supply is required.

WARNING! - A portable power generator is not recommended. The opener may appear to malfunction due to spikes, surges and fluctuations in the generated voltage.

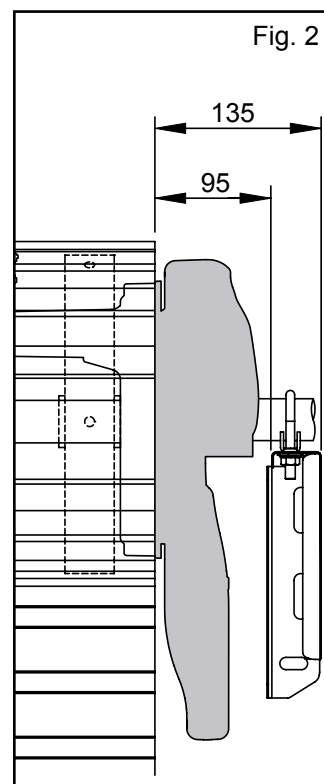
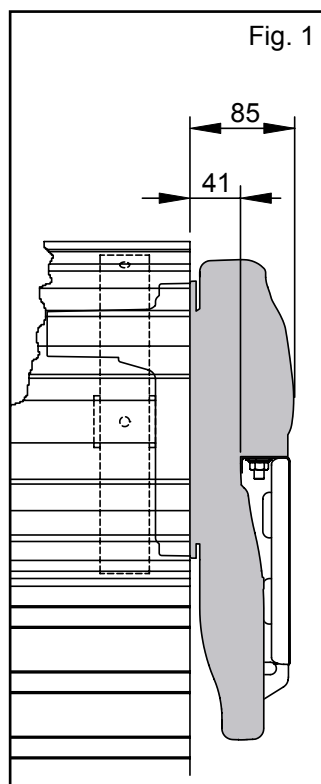

1.4 - SIDE ROOM

Figures 1 and 2 show the minimum and recommended side room that is required to mount the opener. The distance between the edge of the door curtain and the inside of the bracket must be at least 41mm with a total side room requirement of 85mm. However, for easier access it is recommended that at least 95mm is allowed for between the curtain and bracket and a total of 135mm from the edge of the curtain to the wall.

Note: **Door Axle Diameter not to exceed 35mm**

SECTION 2 - INSTALLATION PROCEDURE

The following is the preferred method for installing the opener.

Step 1 - PREPARATION

- a. Check the door operation:
 - i. The door must travel smoothly and be easy to operate by hand.
 - ii. Operating force on the bottom rail should be approximately 70N (7kgs) force.
 - iii. Adjust the guides if they are tight or twisted.
 - iv. Clean the guides if there is any oil or wax present using a suitable white spirit. The only lubricant suitable for use on door guides is silicon spray. **DO NOT** use WD-40, RP-7, petroleum grease, or similar.

- b. Install locking bar covers if there are locking bar holes in the guides. (**Fig. 3**)

Note: DO NOT lock your door with the locking bars after installing the opener. Remove or disable the lock using wire or cable ties). This will not affect door security as the opener has an inbuilt locking facility.

- c. Affix the warning labels supplied with this opener in a prominent place where they are clearly visible.
- d. Choose the side where the opener will be installed ensuring there is sufficient sideroom.
(Refer to sideroom requirements - previous page).

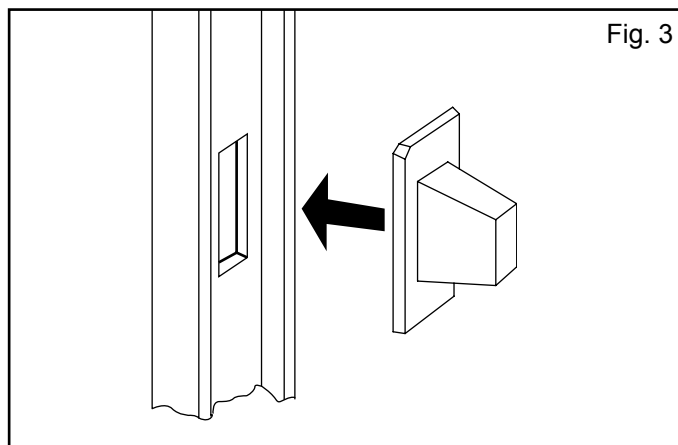

Fig. 3

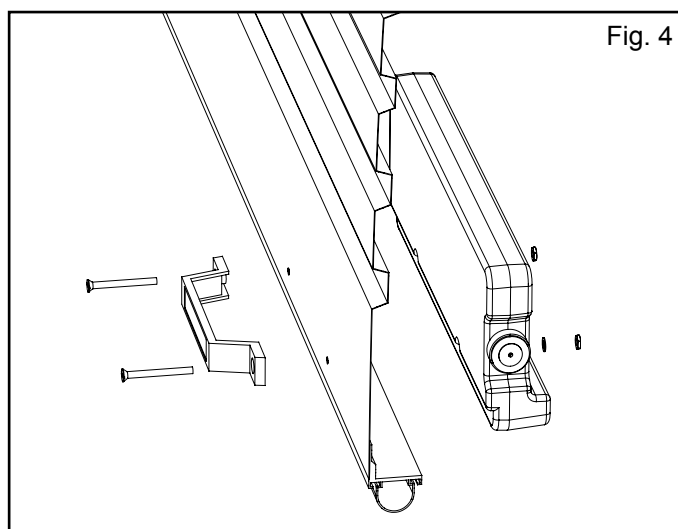

Fig. 4

Step 2 - FITTING THE WEIGHT BAR

The weight bar must be fitted to the bottom-centre of the door as follows:

If the door has a handle: (**Fig. 4**)

1. Remove the door handle, and
2. Fit the weight bar and refit the handle using the new fasteners provided

If the door does not have a handle: (**Fig. 5**)

1. Locate the centre of the door at the bottom rail.
2. Place the weight bar at this point (there is a centerline marked on the weight bar) and mark the two positions where the fasteners will go.
3. Drill the two 4.5mm holes in the door and fit the weight bar using the new fasteners provided. (**Fig. 6**)

Check that the door is balanced and smooth to operate. If it is not then the door may require servicing (refer to door manufacturer's instructions).

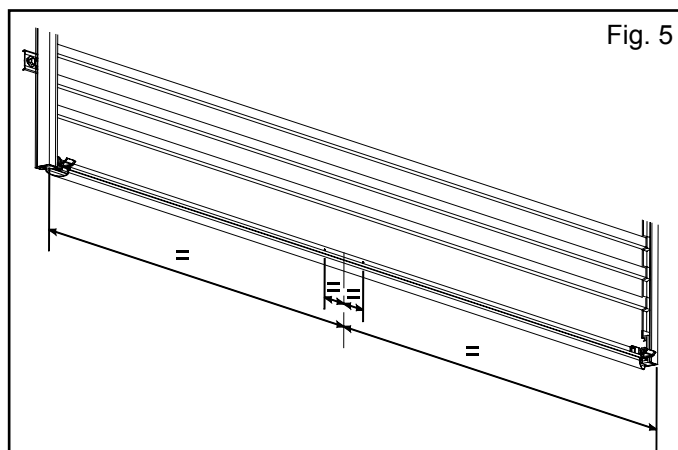

Fig. 5

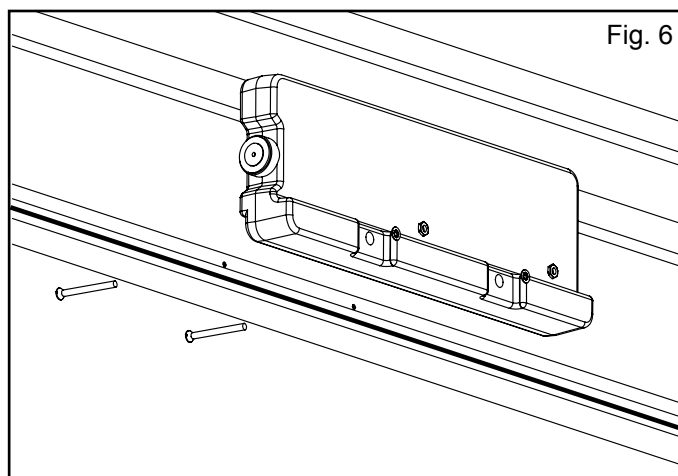

Fig. 6



The door is held under significant tension. Adjustments should only be carried out by experienced persons, as this function can be dangerous if not performed under strict safety procedures.

INSTALLATION

Step 3 - PINNING THE DOOR CURTAIN

Pin the door curtain to the door drum at each end of the door to maintain security when the opener closes and locks.

With the door fully closed:

1. Mark positions to drill in both end of the drum. (**Fig. 7**)
2. Open door slightly to get access to these positions.
3. Drill using 3.2mm (1/8") drill.
4. Fit a No 10 x 32mm screw and washer to each end.
While this screw should be positioned as low as possible, make sure that it does not alter the curtain's normal approach to the guide (lead-in angle).

NOTE: Make sure that the screws do not project into the area where the ring gear will fit.

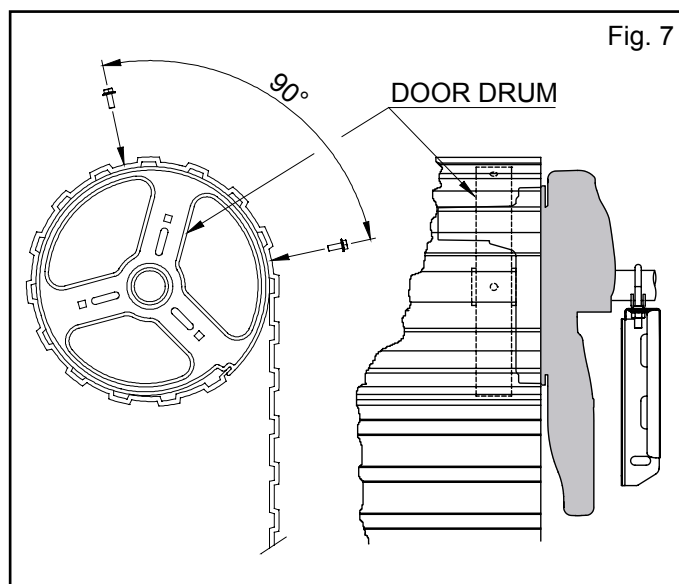

Step 4 - FITTING THE OPENER

1. At the end opposite to where the opener will be fitted, check to make sure the "U" bolt is tightened securely and fit the anti-coning collar to the axle ensuring it is in contact with the door drum - right hand fitting is recommended where possible.
2. Open the door completely and tie two safety ropes around the door roll approximately 300mm from each end (not too tight) as a safety precaution.
3. At the end where the opener is to be fitted, support the door. It is recommended that you support the door with either:
 - a sling or a block and tackle from above the door, or
 - a suitable stand e.g. a ladder and blocks (see illustration). If you use blocks make sure they are flat on the top of the ladder and that they are wide enough to take the weight of the door without damaging it.

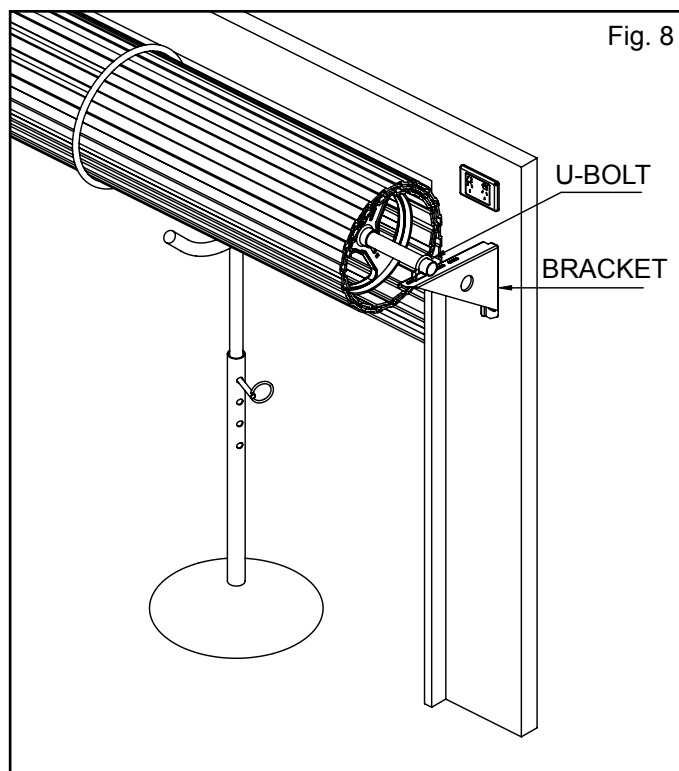

Warning - Make sure the support is snug under the door and that both the support and door are stable and will not move.

4. Mark the position of the "U" bolt in the door bracket and the position of the door bracket on the wall to assist when reassembling (use masking tape or marking pen).
5. Remove the "U" bolt (or bolts) and saddle from the door bracket at the end where the opener is to be fitted.
6. Remove this door bracket allowing the door to rest on the support. (**Fig. 8**)

Note: For minimum sideroom installations the door may have to be taken down.

INSTALLATION

Step 5 - ASSEMBLING THE RING GEAR

1. Insert the two forks into the ring gear as per Fig. 9.
2. Secure with M6x45 hex head screw and washer.

Step 6 - MOUNTING THE OPENER

1. If the ring gear does not rotate freely switch the opener to manual by pulling the disengagement handle down (there will be a click), so that the ring gear can be rotated by hand.
2. Slide the opener over the door axle and into the drum of the door. Ensure the ring gear is pushed in as far as possible (without interfering with the door curtain) so that the drive fingers completely engage one of the door drum wheel spokes. Ensure the edges of the door drum wheel spoke do not have any rough edges (the ring gear drive finger moves on the spoke as the door turns).
3. Re-attach the door bracket using your reference marks as a guide and tighten the bolts. Ensure that the slots in the mounting bracket of the opener align with the slots in the door bracket - the door bracket may have to be relocated.

Note: If the bracket cannot be relocated, the opener may be fitted onto the axle as follows:

4. Using your reference marks as a guide, refit the U bolt and saddle and tighten firmly.

Note: The Series 2 style cast saddle will need to have 1mm ground off both sides to fit into the opener mounting bracket.

5. Adjust the door position (if necessary) on the brackets so that the door feeds smoothly into the guides. Make sure that the center of the door doesn't hit the lintel and that the curtain is not pushed forward hard into the guide.

6. Remove the support and safety ropes.

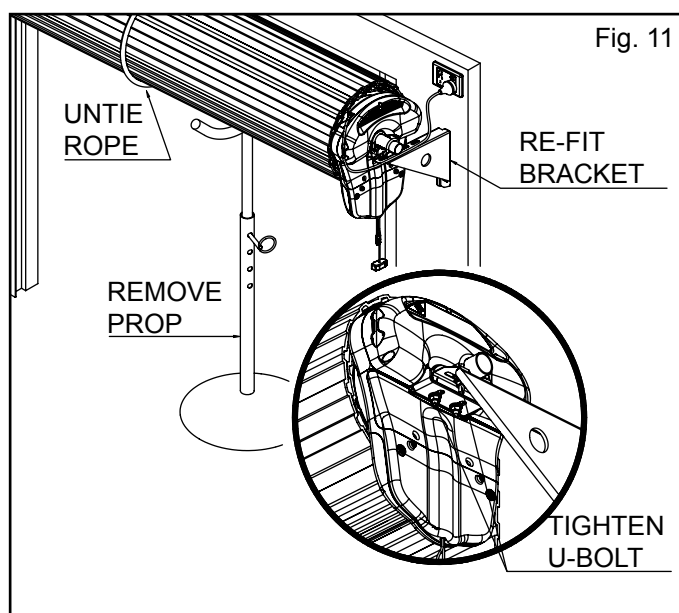
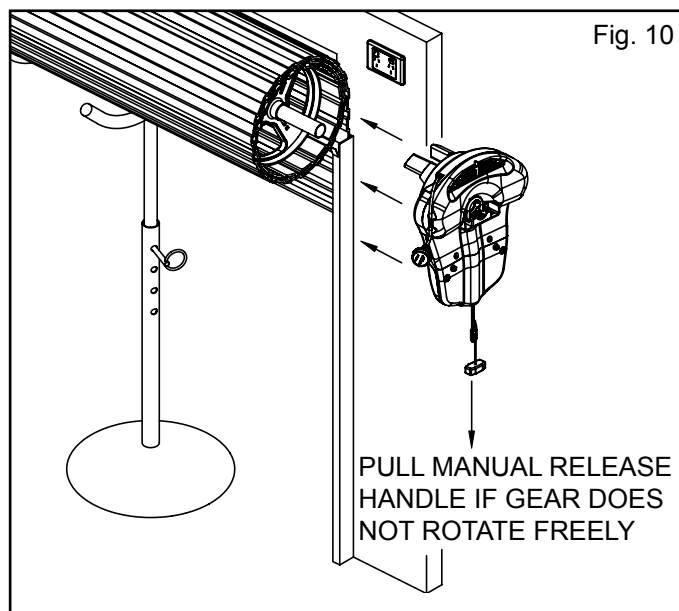
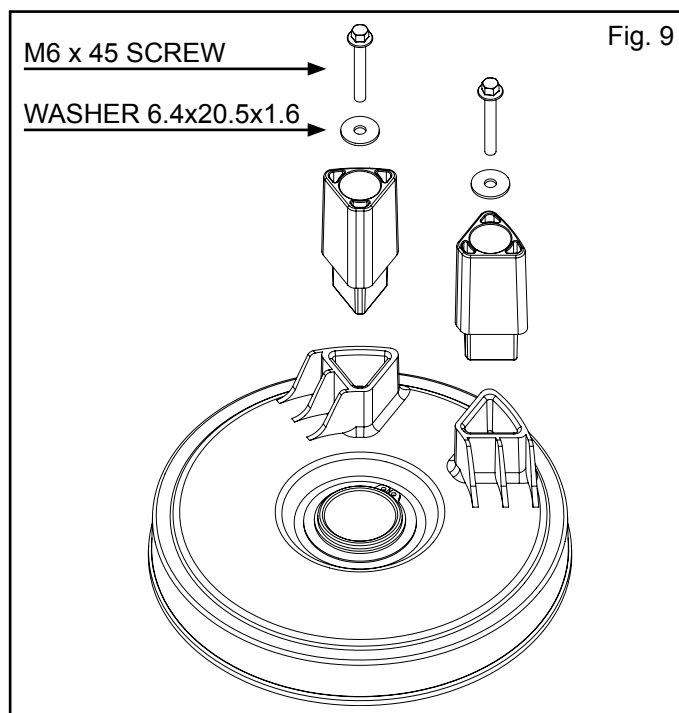

If the manual release handle is more than 1.8 metres from floor level when the opener is installed, extend the handle to a height less than 1.8 metres.

AS3350

7. Connect the power cord to a suitable power point – **do not switch on**. Secure the cord away from any moving object (e.g. the door) with the cable clip supplied.
8. Pull the door up and down to make sure it runs freely – make sure the ring gear is still disengaged.

PROGRAMMING THE OPENER

For the garage door opener to function properly the Door Travel Limits, Door Travel Force Settings and Remote Control Transmitter Codes will need to be programmed.

For normal operation of the garage door opener there are 3 steps, for optional advanced features see Programming Optional Remote Control Transmitter Features. To program the opener proceed as follows:

Step 7 - Setting Door Travel Limits

Door Travel Limits must be programmed into the opener to set the desired range of movement of the garage door. Whenever the Door Travel Limits are programmed the garage door opener will be forced to re-learn the Door Travel Force Margin and reset the Service Counter.



Use caution when operating the manual release with the door open since it may fall rapidly due to weak or broken springs, or an improperly balanced door; AS3350

Caution: Do not disengage the opener to manual operation with children, persons or any objects including motor vehicles within the doorway.

Note: If a P.E beam is to be used it must be installed before setting the travel limits.

Note: This opener features soft start/soft stop. During limits set up the door can be inched slowly for fine adjustment by pressing Plus (+) or Minus (-) buttons briefly.

1. The operator should still be disengaged, if not, disengage the opener by pulling down the red handle.
2. Manually move the door until it is half open.
3. Re-engage the opener by pulling down the red handle. Turn on the power to the opener, the Close Limit LED will illuminate and start flashing to indicate that the close limit must be set.
4. Press and hold the Minus (-) button, the door should starting moving.

Note: If the door starts to open release the Minus (-) Button and Press the Operate Button once, this will change the motor direction. Press the minus button again to confirm that the door closes.

5. Release the button when you reach your desired Close position. If the door over travels the limit position press the Plus (+) button to move the door in the open direction.

Fig. 12

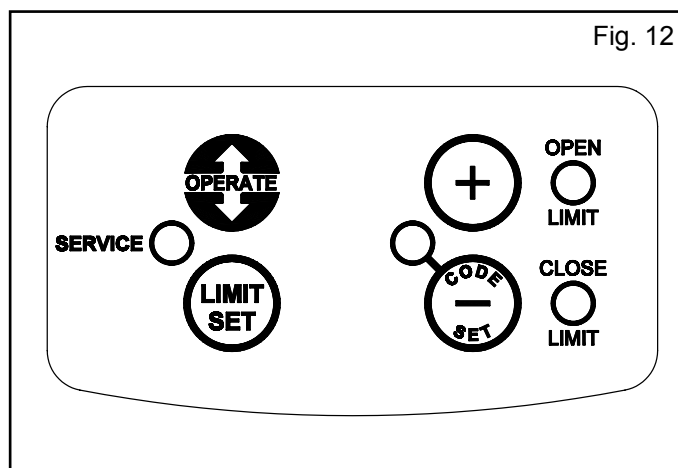

6. When the door is in the desired Close position press the LIMIT SET to record the Close limit position. The Open Limit LED will now flash to indicate that the open limit must be set.
7. Press and hold the plus (+) Button, the door should starting moving, release the button when you reach your desired Open position. If the door over travels the limit position Press the minus (-) Button to move the door in the close direction.
8. When the door is in the desired Open position Press the LIMIT SET to record the Open limit position and start to initiate the self learning cycles.

CAUTION: The door will start to close and open automatically, keep clear of door until it has stopped and a beep is sounded to indicate the learn cycle is complete.

Note: To clear the recorded limits (if already set) press and hold the Limit Set button for 6 seconds until the Close Limit LED is flashing quickly. If the close limit is not set and no action is taken by the installer for 30 seconds, then the controller will reset and the original limits setting will be restored.

Important: A sudden change in the force required to operate a door such as a gust of wind, may result in the garage door opener reversing whilst closing or halting whilst opening. You should always watch the door to ensure it is fully closed before leaving.

PROGRAMMING THE OPENER

Step 8 - REMOTE CONTROL TRANSMITTER CODE SETTING

The garage door opener can only operate from remote control transmitters that have been programmed into the opener's receiver. The receiver needs to learn the codes of any remote control transmitter that will be used with the operator. Up to 14 codes can be stored in the receivers memory.

- Up to **12** "Smart Code" remote control transmitters. After 12 codes have been stored, any additional code stored will cause the oldest code to be erased.
- **One** "dip-switch" remote control transmitter code. Note: Programming a different dip-switch code will automatically erase any previously programmed dip-switch code, and
- **One** "entry keypad" code. Programming a different entry keypad code will automatically erase any previously programmed entry keypad code.

8.1 - Code Setting The Receiver With Smart Code, Manual Release Or Dip Switch Transmitters

1. Make sure that the battery is set in the Transmitter.
2. Press the Code Set button on the opener, the Code Set LED will illuminate to indicate the opener is in Code Learn mode. If a valid code is not stored within 15 seconds the opener will exit Code learn.
3. **Smart Code Transmitter** – Press and hold the remote control transmitter button to be programmed until the Code Set LED flashes to indicate that it has been learnt.

Dip Switch Transmitter – Select your dip switch combination of switches by sliding them on or off, now press and hold the remote control transmitter button to be programmed until the Code Set LED flashes to indicate that it has been learnt.

4. Release the button on the remote control transmitter – the code is set.

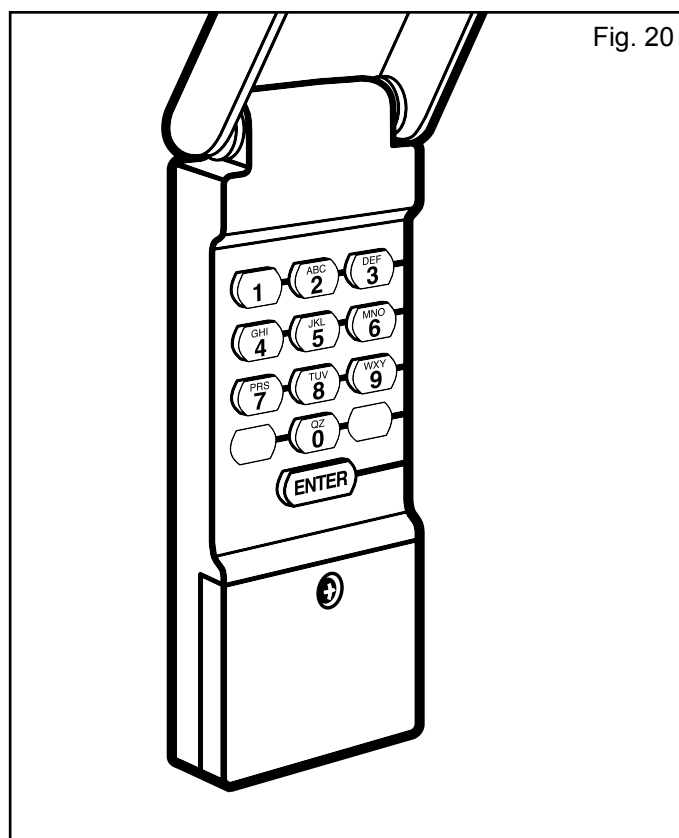
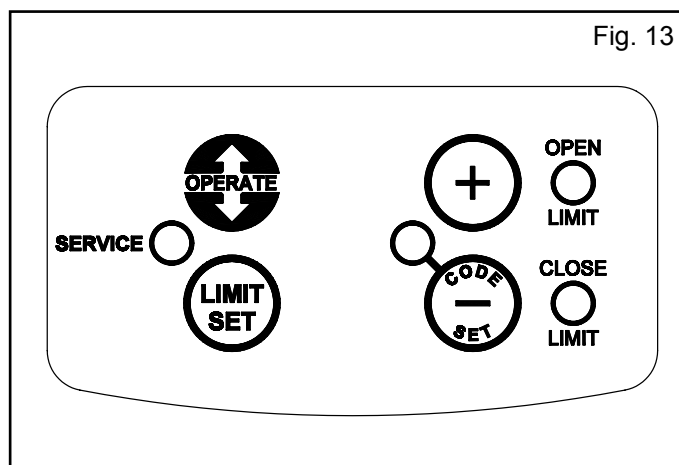

8.2 - Code Setting The Receiver With Entry Key Pad Transmitter

1. Make sure that the battery is set in the Key Pad Transmitter.
2. Press the Code Set button on the opener, the Code Set LED will illuminate to indicate the opener is in Code Learn mode. (if a valid code is not stored within 15 seconds, the opener will exit Code Learn).
3. For an entry keypad the desired code should be typed (a minimum of four numbers or letters) and the ENTER button held down until the Code Set LED flashes to indicate that it has been learnt.
4. Release the button on the remote control transmitter – the code is set.

SAFETY TEST

Step 9 - TESTING THE SAFETY SYSTEM

The opener automatically adjusts the force required to reverse when closing or to stop when opening when an obstruction is encountered. The operation of the Safety System must be tested whenever there has been any change in settings or any adjustment to the door, and monthly during the operational life of the opener.

To test the safety system the following procedure should be used.

9.1 - Door Closing Test

1. Ensure that the door is open.
2. Place a 50mm obstacle laid flat on the floor under the middle of the garage door.
3. Operate the door in the close direction; the door must reverse on hitting the obstruction.
4. If the door fails to reverse, remove the obstacle and reset the door travel limits as per Step 5.
5. Place the 50mm obstacle on the floor under the garage door and then retest.

Important Note: If the door fails again, there may be a problem with your garage door or opener, put the opener into manual operation and do not use. Operate the door manually; you will need to call for service.

9.2 - Door Opening Test

1. Ensure that the door is closed.
2. Operate the opener to open the door.
3. While the door is opening (approximately 1 metre off the floor) hold the bottom edge of the door with your hand. When a reasonable downward force is exerted, the door should halt.
4. This will cause the LED's to start flashing to indicate an open obstruction has been detected.
5. If the door fails to halt, operate the opener for five cycles and then re-test. If the door fails again you will need to call for service.

Note: Check to make sure the door opens and closes properly.

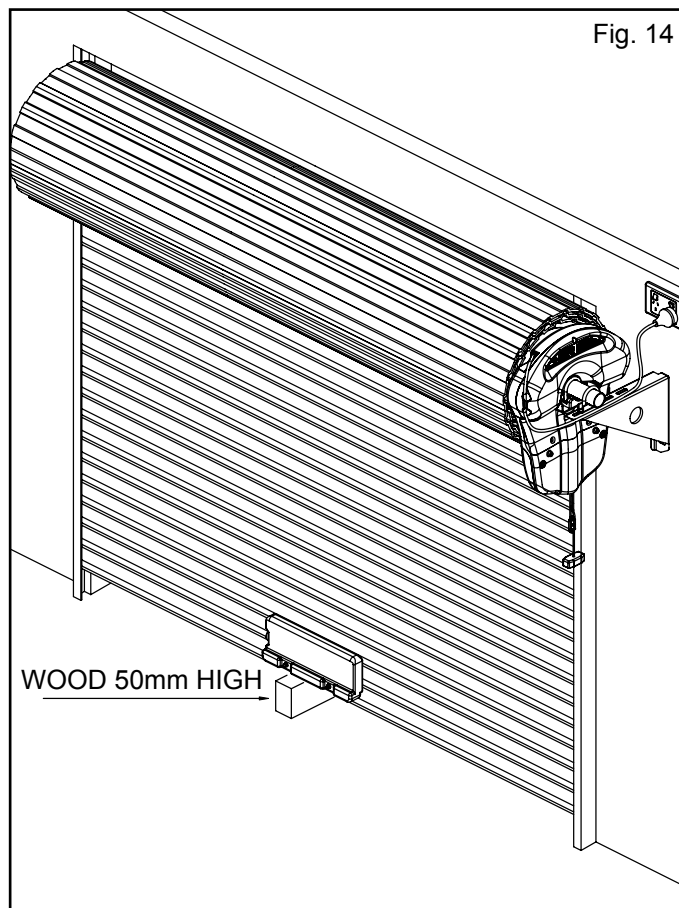

The safety system is designed to prevent entrapment or serious injury. It relies upon physical contact with objects in the path of the door. The safety system alone may not prevent cosmetic damage to motor vehicles or property.

Important Note: The use of safety infra red beams (Part No 062153) is recommended on all installations of automatic garage door openers.

SPECIAL FEATURES

Step 10 - PROGRAMMING SPECIAL FEATURES

10.1 - Programming Optional Remote Control Transmitter Features.

You can program each button of your multi channel remote control transmitter so that each button performs a different function. You can program each button of a multi channel remote control transmitter to activate one of the following features:

- To “Operate” the garage door opener – See Step 3,
- To switch on the “Courtesy Light” independent of door operation – See 2.7,
- To activate the “Vacation Mode” – See 2.8,
- To activate the “Pet Mode” – See 2.8, or
- To operate the “Auxilliary Output” – See 2.10.

10.2 - Code Setting “REMOTE COURTESY LIGHT”:

Although the courtesy light comes on with each operation of the opener, the courtesy light may also be controlled by a remote control transmitter without operating the door. To code one of the remote control transmitter buttons to turn the courtesy light on and off:

1. Press Code Set button twice, the Code Set LED will start illuminate and courtesy light will turn on to show that you are learning the code for controlling the courtesy light.
2. Choose a button on the transmitter that is not already coded into the receiver, press this button whilst in courtesy light learning mode and the courtesy light will go out to indicate the receiver has stored this code.

The Courtesy Light can now be turned on or off by the coded remote control transmitter.

Note: Light time is adjustable with the use of a programmer.

Note: Up to 12 “Smart Codes”, one “Dip Switch Code” and one “Keypad Code” can be stored to operate the courtesy light.

10.3 - Code Setting “VACATION MODE”

The opener can be programmed into a “Vacation Mode” where the opener will not respond to any remote control transmitter as follows:

1. Press Code Set button three times, the Code Set LED will illuminate and the courtesy light will flash slowly (once every two seconds) to show that you are learning the code to operate the “Vacation Mode.

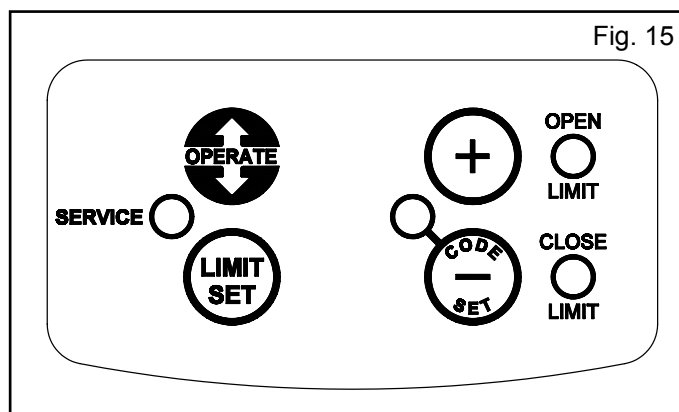

Fig. 15

2. Choose a button on the remote control transmitter that is not coded into the receiver, press this button whilst in Vacation Mode learning and the courtesy light will go out and the Code Set LED will flash rapidly to indicate the receiver has stored this code.

“Vacation Mode” - you can only program one “Smart Code”, one “Dip Switch Code” and one “Keypad Code” to operate this feature. It is recommended that a “Smart Code” remote control transmitter be used as the wall button – program one button to control the “Vacation Mode” feature.

To activate the Vacation Mode facility, with the garage door in the closed position, press the coded remote control transmitter for 5 seconds. The Code Set LED will illuminate to indicate that the opener is in “Vacation Mode”.

To exit “Vacation Mode” press the transmitter button momentarily until the Code Set LED turns off.

10.4 - Code Setting “AUXILLIARY OUTPUT:

It is possible to operate other devices (eg alarm systems) using one of the spare buttons of a multi channel remote control transmitter coded into the Auxiliary Output feature. (Refer to Section 3.3 and 4.4 for description of the Auxilliary Output function).

1. Press Code Set button four times, the Code Set LED will flash slowly and the courtesy light will flash quickly (twice per second) to show that you are learning the code to operate the “Auxilliary Output”.
2. Choose a button on the remote control transmitter that is not already coded into the receiver, press this button whilst in Auxilliary Output learning and the receiver will store this code.

Note: Up to 12 “Smart Codes”, one “Dip Switch Code” and one “Keypad Code” can be stored to operate the Auxilliary Output feature.

SPECIAL FEATURES

10.5 - Code Setting "PET MODE"

The opener can be programmed into a "Pet Mode" where the door opens approximately 200mm to allow pet to enter/exit the garage:

1. Press Code Set button five times, the Code Set LED will illuminate and the courtesy light will flash quickly (twice per second) to show that you are learning the code to operate the "Pet Mode."
2. Choose a button on the remote control transmitter that is not coded into the receiver, press this button whilst in Pet Mode learning mode and the courtesy light will go out and the Code Set LED will flash rapidly to indicate the receiver has stored this code.

Note: Door opening height is adjustable with the use of a programmer.

10.6 - SETTING OPTIONAL REMOTE CONTROL TRANSMITTER DIPSWITCH CODES.

Some remote control transmitters have a dip-switch facility. Generally, dipswitches are used when several persons are operating the same opener. The dip-switches must be set to matching positions in all remotes used to activate the opener.

- Remove the battery cover.
- Set switches in all remote controls to matching positions (+, -, 0). Use a pen or screwdriver.

Replace covers and program this code.

10.7 - TO ERASE PROGRAMMED CODES. If the Code Set button is pressed and held on for 6 seconds, the LED will blink rapidly for one second to indicate that all programmed codes have been erased.

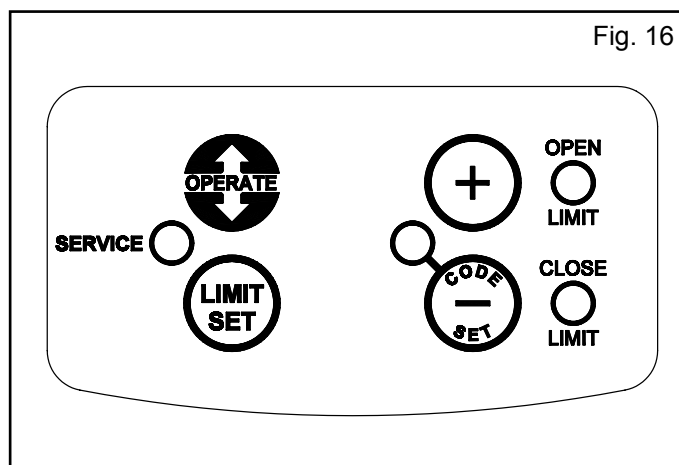

Fig. 16

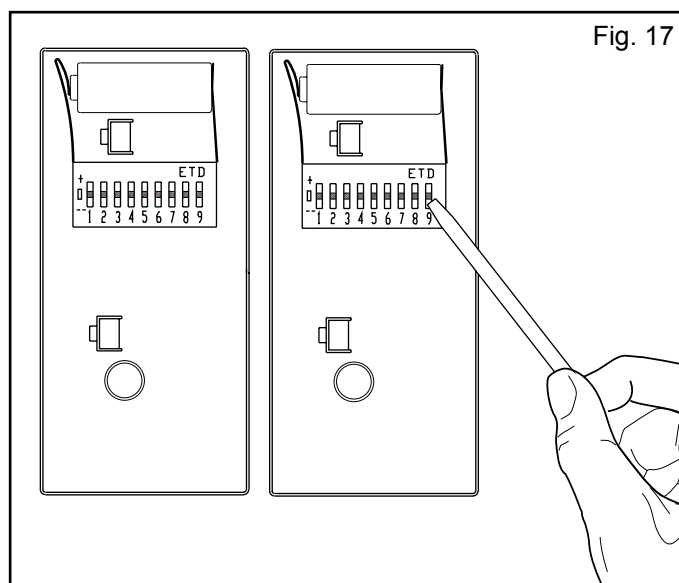

Fig. 17



Permanently fix the label warning against entrapment and manual operation in a prominent place or near any fixed controls. After installation, ensure that the mechanism is properly adjusted and that the opener reverses when the door contacts a 50mm high object placed on the floor under the garage door – see Testing The Safety System.

AS3350

SECTION 3 - ACESSORIES

3.1 - Remote Aerial – Part No 062177

Some sites can cause poor radio reception, ie wherever there is a large mass of metal like all steel garages or underground car parks (large masses of steel reinforced concrete). Metal mass can cause the radio signal to be reduced.

Poor radio reception will be noticed by a reduction in the operating range of the remote control transmitters used on this garage door opener.

You can test to evaluate if fitting an external aerial will benefit as follows:

- test the maximum operating range of the remote control transmitter with the garage door closed; then
- test the maximum operating range of the remote control transmitter with the garage door open.

If the range is improved with the door open then you can install a remote aerial kit to improve the radio reception.

Mount the aerial to a suitable location on the outside of the garage. The radio receiver in your garage door opener is similar to the receiver in your television set; the better the position of the aerial, the better the reception will be. Where possible, mount the aerial as high as possible away from masses of metal and in line of sight to the position where you would normally operate your remote control transmitter.

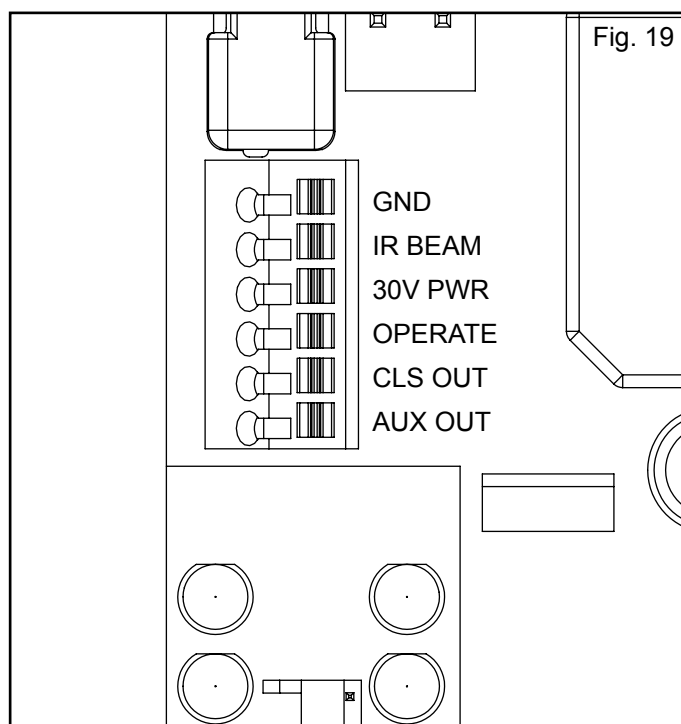
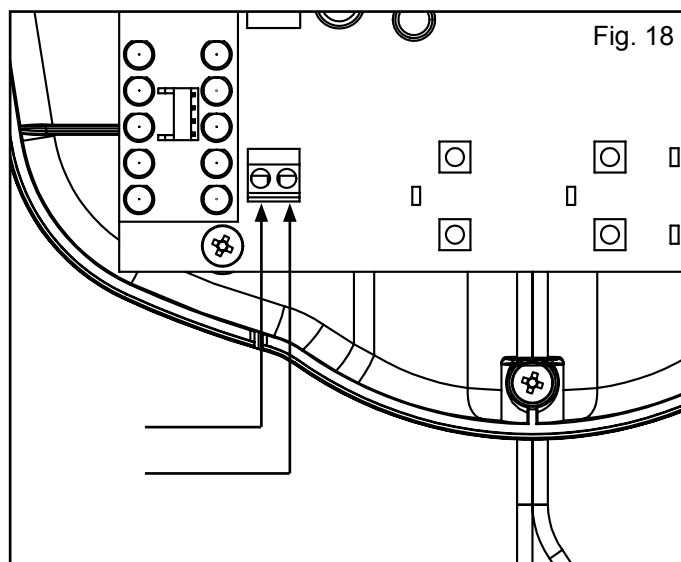

3.2 - Terminal Block

A variety of wired accessory items can be connected to the terminal block situated above the left hand LED light module. You can connect devices such as a Safety Infra-Red Beam, wall switch, door status indicator, etc.

The terminal block also features an auxillary output for controlling other devices from your remote control transmitter. These can include: an alarm system, external lighting, or an automatic gate.

Terminal connections from top down are as follows:

1. GND (Ground, Common, -ve)
2. IR BEAM (Safety IR Beam Input)
3. 30V PWR (+ve)
4. OPERATE (Open/Stop/Close trigger)
5. CLS OUT (Door status indicator output)
6. AUX OUT (Auxillary output trigger)

ACESSORIES

3.3 - Safety Infra-Red Beam - Part No 062153

For ADDITIONAL SAFETY protection we STRONGLY recommend the fitting of a Safety Infra-Red Beam. In most countries Safety Beams are mandatory on all garage doors fitted with automatic openers. For a small additional outlay B&D recommends that Safety Infra-Red Beams be installed with the automatic opener ensuring additional safety and peace of mind.

Locate the IR Beam in a strategic location within doorway. We recommend 150mm above the floor level and as close as possible to the door opening, inside the garage and connect the wires as per Fig. 20.

Note: This opener is only compatible with B&D's Transmitter/Receiver type IR Beam (Order Code: 062153).

Make sure to align the beams correctly. Follow the manual supplied with the IR Beam. Twist the wires from both transmitter and receiver together before connecting to the terminal block as per Fig. 20.

WARNING: When using Auto Close Mode and IR beams, the doorway must be clear of all obstructions and persons at all times. The location of the beam and manner in which it is installed might not give safety protection at all times. Check to make sure that the height of the beam and type used give maximum protection possible.

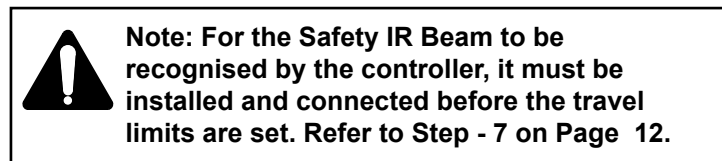
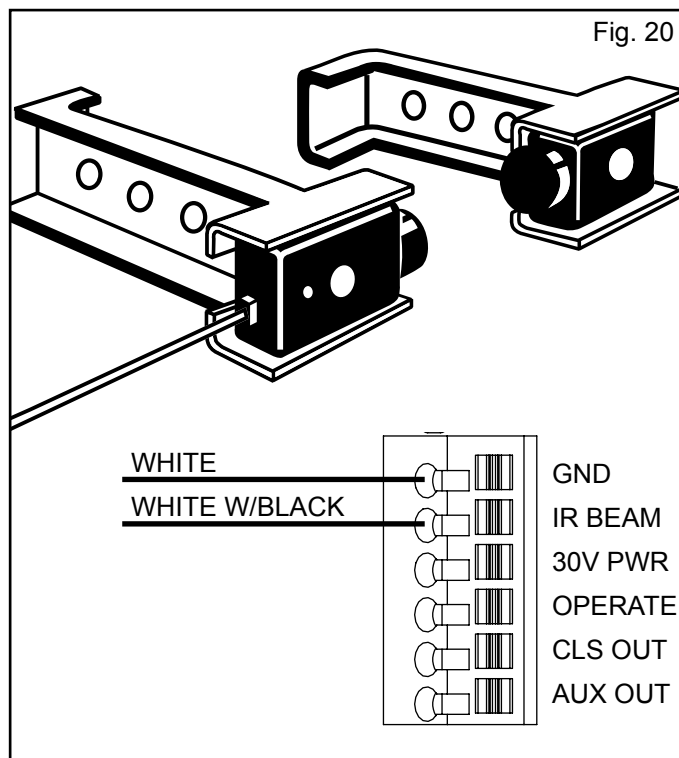

3.4 - Wired Wall Switch/Electric Key Switch

A wired wall switch or electric key switch can be connected to the opener as an alternative to using the remote control transmitter. The electric key switch doubles as an external release mechanism which is ideal if your garage does not have a pedestrian door.

To connect the switch to the opener's terminal block refer to Fig. 21.

The switch behaves just like a remote control transmitter: each turn of the key will cycle through an open - stop - close function.

Note: For installation procedure of the Electric Key Switch/Release please refer to the unit's instruction sheet.

Unit shown in Fig. 21 is B&D Order Code: 059009.

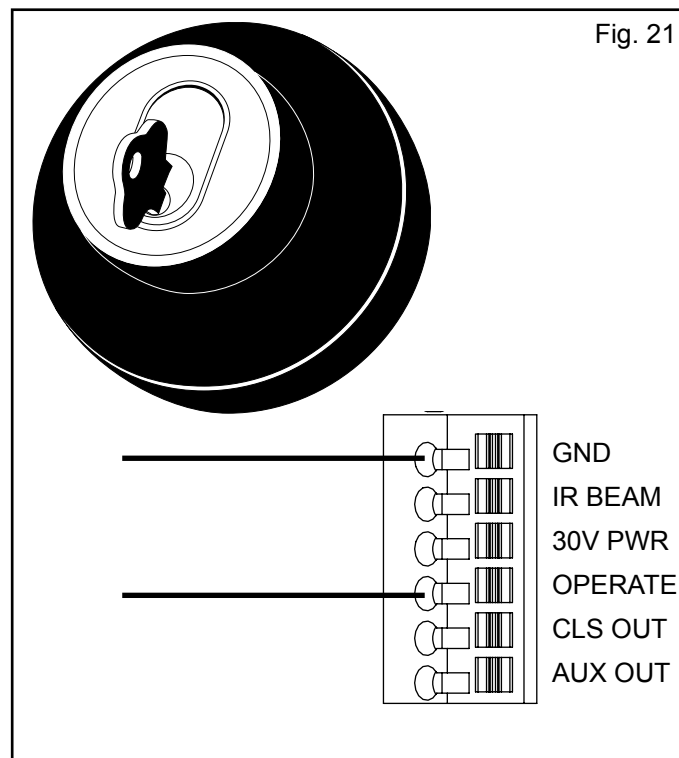

SECTION 4 - HOW TO USE YOUR OPENER

For maximum efficiency of your opener, your garage door must be in good operating condition.

An annual service of your garage door by an authorised dealer is recommended.

(Refer to Warranty conditions in Section 8).

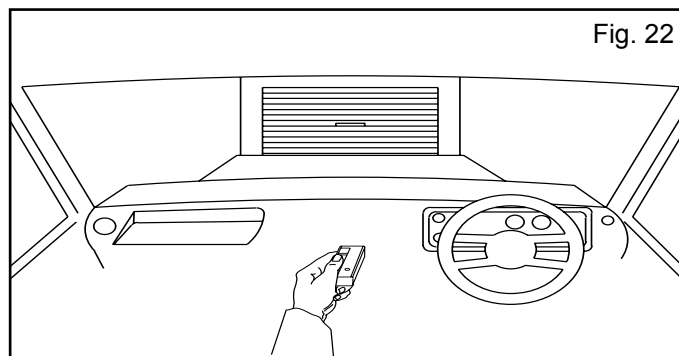

Activate the opener only when the door is in full view, free of obstructions and with the opener properly adjusted. No one should enter or leave the garage while the door is in motion. Do not allow children to play near the door.



This opener is a mains voltage plug in domestic appliance and there are no user serviceable parts inside this opener.

4.1 - Remote Control Transmitter

- To operate the garage door opener, press the programmed button of the remote control transmitter until your door begins to move (usually 2 seconds). For an entry keypad, enter the coded pin number (or name), press and hold the enter button for 2 seconds until the door starts to move.
- Make sure you can see the door when you use the remote control transmitter.
- If you are in a vehicle you should aim the remote control transmitter through your windscreen. If your remote control transmitter has a visor clip, it should be secured to the visor so that when the remote control transmitter is operated it is transmitting through the vehicle windscreen.
- Check that the door is fully closed before you drive away.
- If you press the remote control transmitter whilst the door is moving the door will stop. The next press of the transmitter will move the door in the opposite direction.

The remote control transmitter may also be programmed to operate the following features (see the section on Programming Optional Remote Control Transmitter Features):

- to turn the courtesy light on and off without operating the door,
- to activate the Auxilliary Output,
- to put the door into "Pet Mode" where it opens partially to allow pet access to the garage, and/or
- to put the garage door opener into "Vacation Mode" where it will not respond to any remote control transmitters.

Note: Additional remote control transmitters may be purchased at any time.

HOW TO USE YOUR OPENER

4.2 - Inbuilt Locking Facility

DO NOT lock your door with the locking bars when your opener is engaged. This opener has an inbuilt locking facility. With the opener engaged your door will be locked whether the power is on or off.

4.3 - Manual Door Operation



Use caution when operating the manual release with the door open since it may fall rapidly due to weak or broken springs, or an improperly balanced door. AS3350

Caution: Do not disengage the opener to manual operation with children/persons or any objects including motor vehicles within the doorway.

To disengage the opener from the door, (preferably with the door in the closed position) pull down on the red disengagement handle – you will hear a ‘click’. (Fig. 28)

You may manually open or close the door any time without affecting the pre-set limits.

Pulling down on the red handle again (click) will re-engage the opener, i.e. automatic operation.



Warning: When the opener is manually disengaged, the door is no longer locked. When the door is closed you should either:

- a. Re-engage the opener, or
- b. Use the manual locking bars if fitted to the door. **DO NOT** operate the opener when the locking bars are engaged.

4.4 - Power Failure

When there is a power failure, the garage door opener will be unable to automatically open or close your garage door. To use your door whilst there is no power you will need to disengage the garage door opener and use the door manually – see Manual Operation.

When the power resumes your garage door opener will be automatically reset. The Code Set and Limit Set LED's will flash for a few seconds whilst the garage door opener undergoes a self-test. The Power LED will then come on, returning your garage door opener to normal operation.

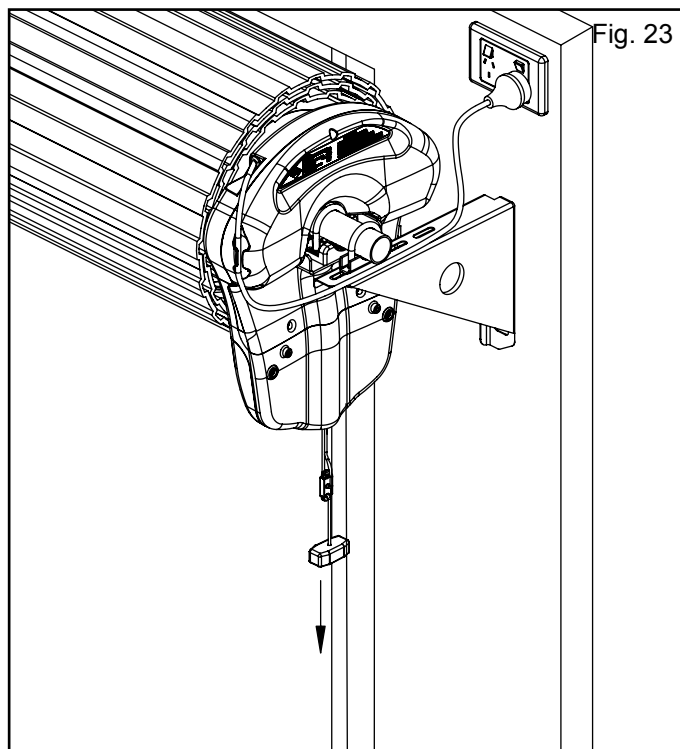

HOW TO USE YOUR OPENER

4.5 - Safety Infra Red Beam Option

A Safety Infra Red Beam Kit (Part No 62153) may be fitted to this opener.

- When this option is fitted, the operation of this device is such that if an object (i.e. car, child, etc) blocks the infra red beam, then the garage door opener will not close the door automatically.
- If the Safety Infra Red Beam is fitted but not operating correctly, then the door once opened automatically, will not close automatically. The door may be closed by reverting to manual operation – see Manual Operation. Refer to the Diagnostic Codes section of this Instruction Manual.

4.6 - Auto Close Option

To have the Auto Close option you must also have a Safety Infra Red Beam (Part No 62153) fitted and functioning. To enable the Auto close function remove the light cover from the garage door opener and remove the AUTO-CLS jumper near the right hand side light module.

When this option is selected the garage door opener will attempt to close the door automatically 30 seconds after opening.

If the Infra Red Beam is interrupted whilst the door is closing (for example by a person walking through the doorway), the garage door opener will stop the door and reverse the door to the fully open position.

If the door does not close automatically, you may close the door using Manual Operation.

4.7 - Remote Control Transmitter Battery

When necessary, remove the cover and replace the battery with the same type. Dispose of the old batteries properly.

4.8 - Courtesy Light

The Courtesy Light will illuminate for approximately 4 ½ minutes each time the door is operated automatically.

Spare buttons of multi channel remote control transmitters (Smart Code or Dip Switch Code) or an entry keypad can be programmed to turn the light on and off by remote control.

When the Courtesy light is operated by a remote control transmitter it will turn off after approximately 4 ½ minutes.

Note: Light time is adjustable with the use of a programmer.

4.9 - Auxilliary Output

The radio receiver of this garage door opener can be used to operate other devices. Connect an interface cable kit to the terminal block on the opener control board and the device to be controlled (eg an alarm panel, security lights, etc).

Program a spare button of a multi channel remote control transmitter (Smart Code or Dip Switch Code) or an entry keypad, to operate the Auxilliary Output feature of this garage door opener. When the programmed remote control transmitter is operated it will cause the contacts to close momentarily.

4.10 - Vacation Mode

The radio receiver of the garage door opener can be turned off using a remote control transmitter to activate the Vacation Mode facility. Whilst in vacation mode the opener will not respond to any remote control transmitters.

To activate the Vacation Mode facility, with the garage door in the closed position, press the coded remote control transmitter for 5 seconds. The Code Set LED will illuminate to indicate that the opener is in "Vacation Mode".

To exit Vacation Mode press the transmitter button until the Code Set LED turns off.

You may program one "Smart Code", one "Dip Switch Code" and one "Keypad Code" to operate this feature. It is recommended that a "Smart Code" remote control transmitter be used as the wall button – program only one button to control "Vacation Mode". This will reduce the possibility of accidental activation of this feature.

4.11 - Pet Mode

A remote control transmitter can be programmed to open the door partially (approximately 200mm) to allow pet access to the garage.

To activate Pet Mode press the transmitter button that has been programmed for Pet Mode - the door will open partially. Pressing the button again will return the door to the closed position.

4.12 - Door Status Indicator

This garage door opener has a Door Status Indicator when the garage door is fully closed. For example, this can be wired into home automation systems.

Note: If the power fails, door status will be lost and can only be restored once power is returned and a close cycle has been performed.

SECTION 5 - MAINTENANCE

5.1 - Maintenance

The Service LED will indicate the requirement for a service and/or adjustment. To reset the Service LED when the door is serviced, reprogram the Door Travel Limits and the Door Travel Force – on completion of this programming the Service LED will go out.

Whilst your opener does not require any periodic maintenance, the door that it is fitted to does. Your garage door is a large, heavy, moving object and should be tested regularly to ensure it is in good condition. A poorly maintained door could cause fatal or serious injuries.

To ensure long and trouble free life of your opener the following is recommended:

5.2 - Monthly

- Disengage the opener and manually operate the door: The door must be smooth to operate by hand, an operating force on the bottom rail should not exceed 200N (20kg) force.
- Each month check that the opener reverses when the door contacts a 50mm high object placed on the floor (AS3350). Refer to Testing the Safety System.

Note: If the door does not operate smoothly, call your nearest Authorised Dealer.

Service Record

Record any maintenance in the following table to assist in any warranty service.

DATE	SERVICED BY	SIGNATURE	INV No.	AMOUNT

5.3 - Yearly

We suggest that you contact your nearest Authorised Dealer to perform an annual door service.



Frequently examine the installation, in particular cables, springs and mountings, for signs of wear, damage or imbalance. Do not use if repair or adjustment is needed since a fault in the installation or an incorrectly balanced door may cause injury.

AS3350

Adjustments should only be carried out by experienced persons, as this function can be dangerous if not performed under strict safety procedures.



Warning: Failure to maintain your garage door may void the warranty on your garage door opener.

5.4 - Warranty Expired Indicator

When the opener reaches the number of cycles covered by warranty the courtesy light will flash 10 times after each operation to indicate that the warranty has expired. This flashing will continue for twenty (20) operations unless the user acknowledges the warranty expiry indicator and stops the light from flashing.

To stop the courtesy light flashing press the LIMIT SET button while the light is flashing after an operation.

SECTION 6 - TROUBLE SHOOTING GUIDE

SYMPTOM	POSSIBLE CAUSE	REMEDY
The opener does not work from either the button on the light cover or the hand remote control transmitter	Garage door in poor condition e.g. springs may be broken Manual door lock engaged The opener does not have power	Check the door for normal operation – see monthly maintenance. Disengage door locks Plug a device e.g. a lamp, into the power point and check that it is OK.
The motor runs but the door does not move	The opener is disengaged	Re-engage the opener
The opener works from the button on the light cover but not from the hand remote control transmitter	The battery in the remote control transmitter is flat The opener has been put into “Vacation Mode” The transmitter code has not been set	Replace the battery Turn off “Vacation Mode” by pressing transmitter button See remote control transmitter & code setting procedure
The remote control transmitter range varies or is restricted	Variations are normal depending on conditions e.g. temperature or external interference The battery is flat or faulty Position of the remote control transmitter in the motor vehicle Position of the aerial will not pick up the radio signal	See Instructions for correct use of remote control transmitter Replace the battery Change the position – see Instructions for correct use Install an external aerial kit – see Accessories Section
The light does not work	Light module is not inserted/connected properly	Check for correct connection otherwise replace module If both fail contact your dealer for support
The door reverses for no apparent reason	This may occur occasionally from weather changes, usually during the first year	The opener automatically adjusts to compensate for changes in the door operating force
The door opens but will not close	Auto close or safety infra red beam not operating correctly	Check the installation

If You Need a Service Call

**If the opener needs service please call the dealer who installed the garage door opener .
(For product assistance contact 1800 636 407 within Australia).**

Before calling for service you should have the following information to assist in providing the appropriate service:

1. **Has anything happened since the door was last operating OK e.g. storm, a jolt to the door etc?**
2. **How easy is it to manually open and close the door?**
3. **What model is the opener?**
4. **Who installed the opener?**
5. **When was it installed?**
6. **Are there any error codes, see the Diagnostic Codes Section of this manual?**

Fault Indicator

When a fault is detected the service LED will start to flash and a number of beeps will sound to identify the type of fault. The fault will be active each time an attempt is made to operate the door. Pressing the LIMIT SET button will reset the opener. If the fault continues to be tripped contact your dealer for assistance.

SECTION 7 - Parts List

Item No.	Description	Order Code
1	DRIVE CHASSIS VR1	
2	CLUTCH GEARED MOTOR ASSY 13 WS	
3	HEX SERRATION HEAD SCREW M6x16	
4	TRANSFORMER TDB-100-143 KIT	
5	CORD GRIP GROMMET SB5P-2	
6	POWER CORD A.S. 1.5M W2P+1R	
7	EMC FILTER BOARD EMC-2.01	
8	PAN HEAD SCREW W/WASHER M4x8	
9	WIRE EARTH ASSY 250L	
10	SUPPORT CHASSIS VR1	
11	GROMMET 101422	
12	TIMING ASSY	
13	TIMING HARNESS ASSY	
14	DUST COVER TOP	
15	TAPTITE SCREW 'P' M4x10	
16	CONTROL BOARD CBR-1 ASSY	
17	CONTROL BOARD CBR-1 V-1.03	
18	LED LIGHT LL1-1.00	
19	LIGHT DIFFUSER VR1 ASSY	
20	MOUNTING BRACKET VR1	
21	TIMING COVER VR1	
22	MAIN COVER VR1 ASSY	
23	INDUSTRIAL SADDLE	
24	CONTROLS COVER VR1	
25	INTERNAL GEAR 8225-40 ASSY	
26	CLAMP WASHER	
27	RETAINING RING STW 45	
28	U-BOLT M8	
29	STRING HANDLE ASSY	
30	HEX SERRATION HEAD SCREW M8x16	
31	PAN SERRATION HEAD SCREW M4x12	
32	HEX SERRATION FLANGE NUT M8 (BLACK)	
33	FLAT WASHER 8.4x18x1.6	
34	ACCESSORY PACK INTERNAL GEAR VR1	
35	EXTENSION FORK 58L	
36	HEX SERRATION HEAD SCREW M6x45	
37	FLAT WASHER 107D 6.4x20.5x1.6	
38	COVER WITH D/S TAPE	
39	WEIGHT BAR	
40	WEIGHT BAR ACCESSORY PACK	
41	COLLAR KIT	

SECTION 8 - WARRANTY

1. Definitions

'B&D' means

- (a) in Australia - B&D Doors of 17 Oasis Court, Clontarf, Queensland, 4019, a division of B&D Australia Pty Ltd (ABN 25 010 473 971), or
- (b) in New Zealand - B&D Doors NZ Ltd of 70 Allens Road East Tamaki Auckland, which is a subsidiary of B&D Australia Pty Ltd.

'Purchaser' means the purchaser of the Opener.

'Opener' means the 'Firmamatic Automatic Garage Door Opener'

'Authorised Distributor' means an authorised B&D distributor of the Opener.

'Major Components' means all components of the Opener that make up the power head that is attached to a garage door.

'Ancillary Components' means all components of the Opener which are not Major Components.

'Manufacturer's Written Instruction Manual' means the instruction manual provided with the Opener.

- 2. This warranty applies to every sale of an Opener to a Purchaser by B&D or its Authorised Distributor, and is the only warranty given on behalf of B&D.
- 3. B&D warrants that it will, at its option, either repair or replace any defects:
 - (i) in materials or workmanship in the Opener, subject to the following:
 - (a) for Major Components of the Opener that are installed by B&D or an Approved Distributor the warranty shall be valid for a period of twenty-four (24) months;
 - (b) for Major Components of the Opener that are not installed by B&D or an Approved Distributor the warranty shall be valid for a period of twelve (12) months, provided that all costs of disconnection, reinstallation and freight shall be borne by the Purchaser.
 - for Ancillary Components of the Opener the warranty shall be valid for a period of twelve (12) months.
 - (ii) in installation for a period of twelve (12) months from the date of installation where the Opener has been installed by B&D or its Approved Distributor.
- 4. The warranties provided in clause 3(i) shall only apply to an Opener which is being used under normal use and service in accordance with the Manufacturer's Written Instruction Manual and are limited to the repair or replacement, at B&D's option, of any defective Opener or parts thereof.
- 5. The warranty provided in clause 3(i) shall apply from:
 - (i) the date of delivery of the Opener by B&D; or
 - (ii) the date of installation of the Opener by B&D or one of its Authorised Installers; or
 - (iii) the date of purchase of the Opener by the Purchaser;whichever is the later.
- 6.
 - (i) Where the Opener has been sold to the Purchaser by B&D, the Purchaser shall make all warranty claims hereunder directly with B&D;
 - (ii) Where the Opener has been sold to the Purchaser by an Authorised Distributor, the Purchaser shall make all warranty claims hereunder directly with the Authorised Distributor.
- 7. The Purchaser will pay for any service call made by B&D or an Authorised Distributor where such a call is made for the purpose of adjustment (as described in the Manufacturers Written Instruction Manual) and not for rectification of a defect pursuant to the warranty hereunder.
- 8.
 - (i) The Purchaser shall be responsible for any expense incurred by B&D or an Authorised Distributor in ensuring that the Opener is readily accessible for any repair work carried out under this warranty.

Where an Opener is installed outside a capital city metropolitan area and a warranty claim is made pursuant to this warranty, any travelling expenses and costs of transporting the Opener, incurred by B&D or its Authorised Distributor, shall be borne by the Purchaser.

WARRANTY

9. Subject to paragraph 12 hereof;
- (i) the obligations of B&D under this warranty are limited to those contained herein and such warranties are expressly in lieu of all other warranties, express or implied, including any implied warranty of merchantability or fitness for a particular purpose and notwithstanding any course of dealing between the parties or custom and usage in the trade to the contrary.
 - (ii) B&D shall not be subject to nor incur and the Purchaser releases B&D from any claim or liability (including consequential loss or damage and loss or use or profit) by reason of delay, defective or faulty materials or workmanship, negligence or any act, matter or thing done, admitted or omitted by B&D.
10. Subject to Clause 12 hereof, this warranty does not extend to and B&D will be relieved of all obligations, responsibilities and liabilities (direct or consequential) in the event that defects in manufacture of the Opener are directly or indirectly in the opinion of B&D due to or result from:
- (i) being fitted to any door or other closing device which is not of the type or condition defined in the Manufacturers Written Instruction Manual as suitable for installation of the Opener.
 - (ii) Lack of proper maintenance or care – failure to have the door serviced annually may void this warranty.
 - (iii) Incorrect and unreasonable use.
 - (iv) Faulty installation or adjustment of the Opener or door to which the Opener is connected where such installation or adjustment is not carried out by B&D or one of its Authorised B&D Distributors.
 - (v) Failure to observe any instructions or directions provided with the Opener or given to the Purchaser by B&D or an Authorised Distributor.
 - (vi) Modifications or repairs made or attempted to be made by any unauthorised person.
 - (vii) Faulty electrical wiring of structures to which the Opener is affixed.
 - (viii) Radio (including citizen band transmissions) or other electronic interference.
 - (ix) Water damage, including effects from rust and corrosion.
 - (x) Use with doors locked.
11. The warranty contained in Clause 3 does not cover batteries or globes and B&D shall not be liable for any defect, malfunction or failure of such items.
12. It is expressly provided that the warranties or any terms and conditions of them or other statement contained in this document or other literature given to the Purchaser shall not be read or applied so as to purport to exclude, restrict or modify or have the effect of excluding, restricting or modifying the application in relation to the supply of the Opener of all or any of the provisions of Divisions 2 and 2A of Part V of the Trade Practices Act, 1974, or the Consumer Guarantees Act 1993 if the purchase is a 'consumer' and purchased the opener in New Zealand, ("The Act") as amended or the exercise of a right conferred by such a provision or any other condition or warranty implied by any relevant State Act or Territorial Ordinance or by the general law and which by law cannot be excluded, restricted or modified provided that to the extent that the Act permits B&D to limit its liability for a breach of condition or warranty implied by the Act, B&D's liability for such breach shall be limited to the payment of the cost of replacing the Opener or acquiring an equivalent Opener or repairing the Opener.
13. This warranty shall be governed by and construed in accordance with Australian law if the opener was purchased in Australia, or New Zealand law if the opener was purchased in New Zealand
14. Upon making a claim under this warranty the purchaser must produce proof of the date of purchase, together with the details set out below:

Purchased From: _____
Installed By: _____
Installed Date: _____

The Purchaser shall complete this certificate and keep it together with a copy of the receipt of purchase in a safe place – production of such information will assist the handling of a claim made under this warranty.

OPTIONAL ACCESSORIES

There is a range of additional accessories for your added convenience and security.

- **Safety Infra Red Beams** - Part N° 062153. Gives additional protection if the door is closing onto your property or person. Simply breaking the beam “stops” the door! Must be fitted if autoclosing feature is operational.
- **Keyring remote control transmitter** - Part N° 062162. Ideal for personal use when entry into the house may be via the garage.
- **Remote Control Transmitter Wall Button** - Part N° 062163. Allows you to operate the opener within 10 metres of the door. Ideal for mounting inside the house.
- **Remote Control Transmitter 3 Channel 433MHz** - Part N° 062170. Get a spare remote control transmitter for your second car or mount it inside the house for convenient operation of your garage door.
- **Entry Keypad** - Part N° 062173. Key in your own 4 digit PIN (Personal Identification Number). Allows you to open the garage without taking a key or remote control remote control transmitter with you. Ideal for children or when out jogging (no need to hide a key!)
- **Combo Access Kit** - Part N° 059009. Keyswitch function will open the door without a remote control transmitter. Can be used to manually disengage the opener, recommended when the garage door is the only access to the garage.
- **Remote Aerial Kit** – Part N° 062177. For sites where radio range may be reduced (metal garages).

Contact your authorized dealer for installation of these accessory items.



When installing Accessories, always follow the manufacturer's instructions included with the product.

QLD Office:	17 Oasis Court, Clontarf 4019.	Ph: (07) 3883 0200
NSW Office:	34-36 Marigold St, Revesby 2212.	Ph: (02) 9722 5555
VIC/TAS Office:	147-153 Canterbury Road, Kilsyth 3137.	Ph: (03) 9237 7766
SA Office:	23 Frederick Road, Royal Park 5014.	Ph: (08) 8447 4747
WA Office:	96 Mulgul Drive, Malaga 6062.	Ph: (08) 9247 8777
NZ Office:	70 Allens Road, East Tamaki, Auckland. www.bnd.co.nz	Ph: (09) 273 8600

B&D Doors is a Division of B&D Australia Pty Limited - ABN 25 010 473 971
www.bnd.com.au